

Phonak

Roger On™

Roger On fitting guide

Verification mode including volume adjustment

This mode allows you to verify the Roger signal according to the ASHA guidelines (www.asha.org) and to adjust the default volume of a Roger receiver from -8 dB to $+8$ dB.

To activate verification mode, switch on the Roger On and hold it close to the Roger receiver (within 10 cm/4 inches), then press and hold the center button for 8 seconds until a 'V' appears on the screen:

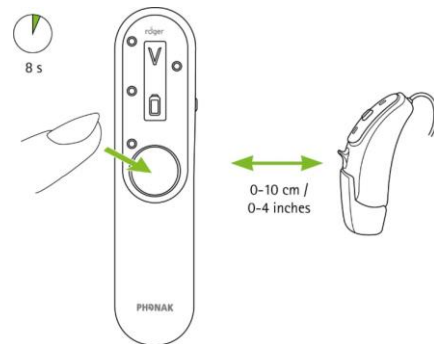

Once you have activated the verification mode, you can increase the distance between Roger On and the hearing aid. Now you can run the verification protocol and adjust the default volume if needed. Simply press the center button to increase the volume by 2 dB. Once $+8$ dB is achieved and you press the center button again, the EasyGain will jump to -8 dB.

The display shows the actual volume, e.g.:

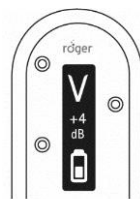

To store the new volume and end the process, press and hold the function key on Roger On for 8 seconds. Repeat the verification and default volume adjustment on the second receiver, if needed.