



## SDS 4.0 Tips and Tricks

# Content

Important information	3
SDS 4.0 Fit and Go Box overview	4
Selecting the receiver length	5
Choosing the correct earpiece for the receiver	6
Attaching/removing the retention to/from the receiver	7
Attaching the dome to the receiver	8
Attaching the SlimTip to the receiver	9
Removing the SlimTip from the receiver	10
How to exchange the receiver	11
Maintenance of domes and custom ear pieces	12
CeruShield™ Disk - wax protection system for SDS 4.0 receivers	13

## Important information

Thank you for choosing a Phonak Receiver-In-Canal (RIC) product, designed to provide comfortable, flexible fittings for your clients.

These assembly instructions provide you with a straight-forward approach to fitting Phonak RIC hearing instruments for long-term satisfaction.

Please note that all SDS 4.0 components are only compatible with Marvel Audéo devices.



Hearing instruments should not be fitted with domes/wax protection system when used by clients with perforated eardrums, inflamed ear canals or otherwise exposed middle ear cavities. In these cases, we recommend the use of a custom earpiece.



In the unlikely case that any part of the system remains in the ear canal, it is strongly recommended to consult a medical specialist for safe removal.



The dome should be changed every three months or when it becomes stiff or brittle. This is to prevent the dome from detaching from the receiver sound outlet during insertion into or removal from the ear.



Changes or modifications made to this equipment not expressly approved by Phonak are not allowed.

## SDS 4.0 Fit and Go Box overview

<b>S Receiver</b> OR 054-0778 OL 054-0777 	<b>M Receiver</b> OR 054-0802 OL 054-0801 	<b>P Receiver</b> OR 054-0813 OL 054-0812 	<b>Cap dome</b> 054-0788 	<b>Retention S Receiver</b> 004-8596-001  <b>Retention M Receiver</b> 004-8597-001  <b>Retention P Receiver</b> 004-8623-001 
<b>S Receiver</b> 1R 054-0780 1L 054-0779 	<b>M Receiver</b> 1R 054-0804 1L 054-0803 	<b>P Receiver</b> 1R 054-0815 1L 054-0814 	<b>Open dome S</b> 054-0785  <b>Open dome M</b> 054-0786  <b>Open dome L</b> 054-0787 	
<b>S Receiver</b> 2R 054-0782 2L 054-0781 	<b>M Receiver</b> 2R 054-0806 2L 054-0805 	<b>P Receiver</b> 2R 054-0817 2L 054-0816 	<b>Vented dome S</b> 054-0809  <b>Vented dome M</b> 054-0810  <b>Vented dome L</b> 054-0811 	
<b>S Receiver</b> 3R 054-0784 3L 054-0783 	<b>M Receiver</b> 3R 054-0808 3L 054-0807 	<b>P Receiver</b> 3R 054-0819 3L 054-0818 	<b>Power dome S</b> 054-0820  <b>Power dome M</b> 054-0821  <b>Power dome L</b> 054-0822 	<b>Measurement tool for cable length</b> 026-0697  <b>Pin removal tool</b> 002-0404-1  <b>Receiver Handling Tool for SlimTips 4.0</b> 026-1119 
<b>CeruShield™ Disk</b> 098-0445 				

## Selecting the receiver length

1. Position your head at the same horizontal level as the client's head so you are looking straight into the client's ear. (a)
2. Hold the measurement tool with the appropriate blue or red color code marking so your thumb is placed on the colored area. (b)
3. Place the measurement tool on the top of the ear. Keep the lines on the measurement tool horizontal. (b)
4. Choose the number (0, 1, 2, or 3) on the measurement tool which is closest to the top of the opening of the ear canal. In this example, 0 would be the most accurate choice. (c)
5. For binaural fittings, repeat process on the opposite ear.

### Note:

It is important to measure both ears for a binaural fitting since right and left ear sizes can vary and thus, require different receiver lengths.

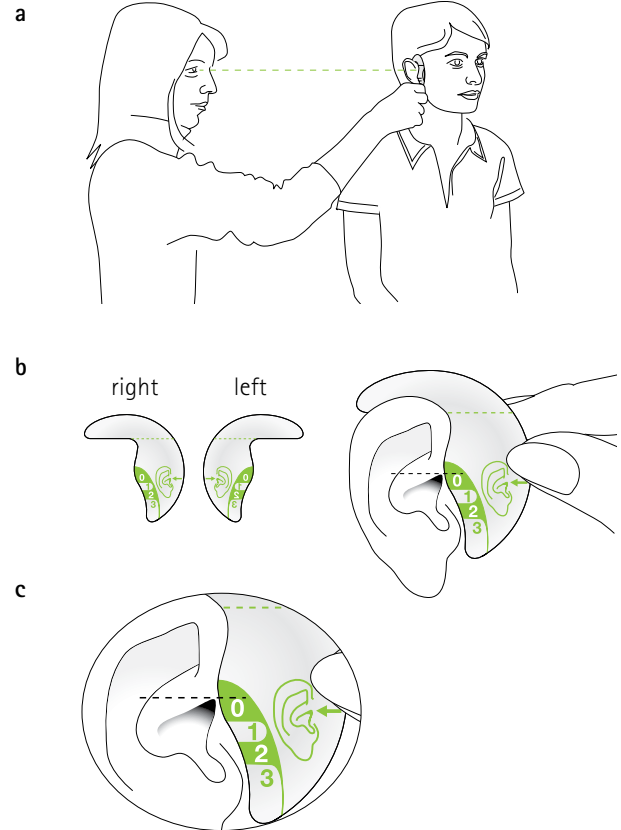



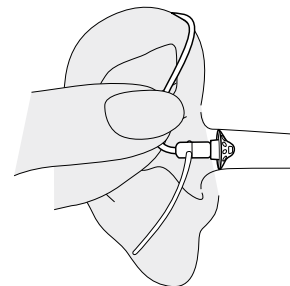

## Choosing the correct earpiece for the receiver

### Dome size

Perform an otoscopic examination of your client's ear canal. Based on the examination, choose a dome size diameter and length suitable for the ear canal. The dome should fit snugly and comfortably into the opening of the client's ear canal, shown in the figure, and help to retain the receiver inside.



Domes				Custom ear pieces	
Cap	Open	Vented	Power	SlimTip	cShell*
					
<ul style="list-style-type: none"> <li>Instant fit</li> <li>Open fit</li> <li>One size only</li> </ul>	<ul style="list-style-type: none"> <li>Instant fit</li> <li>Open fit</li> <li>Sizes S, M, L</li> </ul>	<ul style="list-style-type: none"> <li>Instant fit</li> <li>Semi-occluded fit</li> <li>Wider fitting range than Open dome</li> <li>Sizes S, M, L</li> </ul>	<ul style="list-style-type: none"> <li>Instant fit</li> <li>Occluded fit</li> <li>Expanded low frequency response</li> <li>Sizes S, M, L</li> </ul>	<ul style="list-style-type: none"> <li>Custom fit</li> <li>Choice of venting</li> <li>Impression required</li> <li>SlimTip available in Acrylic, Silicone and Titanium material</li> <li>cShell available in Acrylic only</li> </ul>	

\*There are no coupling instructions for cShell as it is pre-assembled. Receiver with cShell can only be exchanged by manufacturer.

## Attaching/removing the retention to/from the receiver

We recommend using the retention for a more stable positioning of the receiver in the ear canal. It can easily be pre-shaped (to suit the concha) by sliding it over a sharp edge.

### Attaching the retention

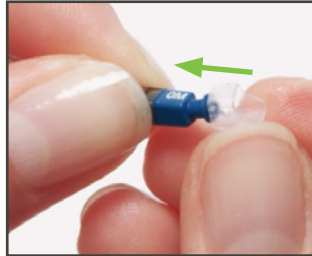

1. Hold the receiver firmly in one hand with the receiver name (e.g. OM) facing upwards. With the other hand hold the retention at the base of the filament.

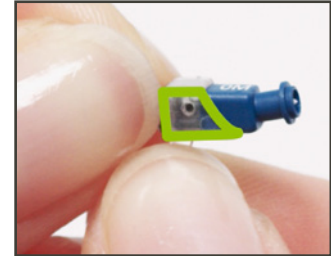

2. Slide the retention over the receiver spout until you feel it click into place. The receiver name should still be clearly visible.

### Removing the retention

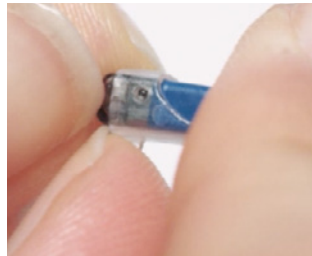

1. Hold receiver firmly with one hand.

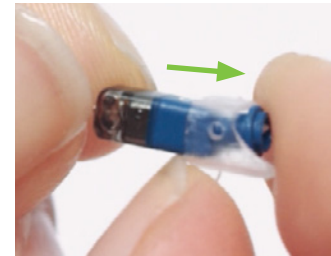

2. Slide the retention forwards over the receiver spout.

## Attaching the dome to the receiver

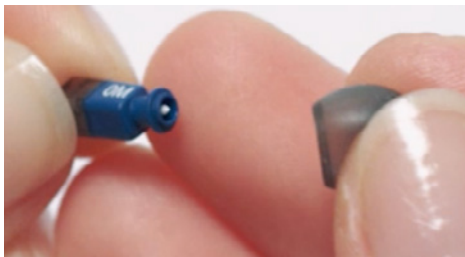

1. Hold the receiver in one hand and the dome in the other hand.

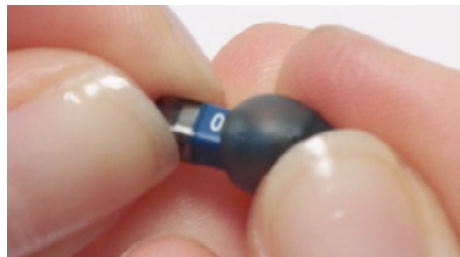

2. Slide the dome over the receiver spout.  
You will feel the dome "click" into place.



In very rare cases, the dome can remain in the ear canal when removing the receiver from the ear. In the unlikely case that any parts remain in the ear canal, it is strongly recommended to see a medical specialist for safe removal.

## Attaching the SlimTip to the receiver

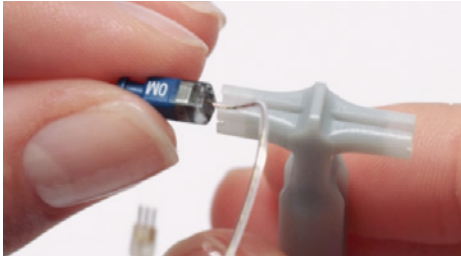

1. Slide the receiver into the sleeve of the handling tool, ensure the receiver label (e.g. OM) is visible and facing upwards, and the receiver cable is extending upwards. Note that the tool has three different sized sleeves to accommodate S, M and P receiver housings.



2. Hold the SlimTip firmly with one hand, with the other hand insert the receiver using the handling tool. **Note that the printed label on the SlimTip faces the opposite direction to the receiver label.**



3. Gently insert the receiver spout into the SlimTip Link until you feel it click into place securely.



4. Gently slide the tool away from the receiver.

## Removing the SlimTip from the receiver



1. Hold the SlimTip firmly in one hand.

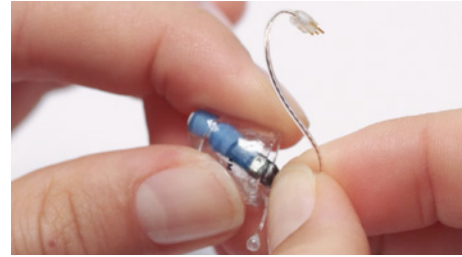

2. With the other hand, firmly grip the receiver at the base of the cable.



3. Detach the receiver from the SlimTip with a firm pull.

### Note:

There is no tool for removing SDS 4.0 receivers from the SlimTip. Please do not insert any tool into the SlimTip opening to push the receiver out.

## How to exchange the receiver

### Remove the receiver

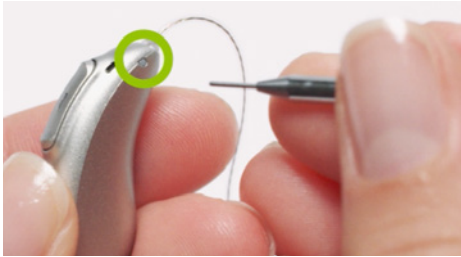

1. Use the pin removal tool to push the pin (circled).

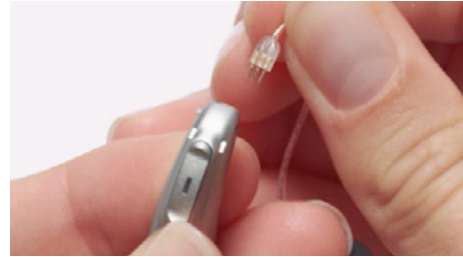

2. Gently pull the receiver away from the hearing aid.



Do not twist the receiver when removing. Twisting could cause damage to the wires.

### Attaching the receiver



1. Align the 3 pins with the 3 sockets in the hearing aid. Gently slide the cable into the sockets until securely in place.

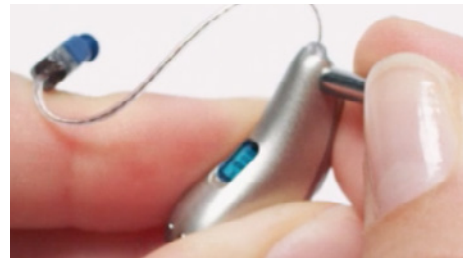

2. Push the pin back into place to lock the receiver into position.

## Maintenance of domes and custom ear pieces

### Domes

All domes are designed as the first line of defence against wax. At the tip of each dome is a small shield that protects the sound inlet (indicated by the green arrow). Domes should be changed at least every three months or when they become stiff or brittle. The client should wipe the dome daily with a dry tissue.



Cap Dome



Open Dome



Vented Dome



Power Dome

### Custom earpiece

Earpieces should be wiped daily with a dry tissue. We suggest checking the tip of the ear piece regularly and exchanging the wax filter when necessary.

### To change the CeruStop wax filter



1. Insert the CeruStop stick into the filter.

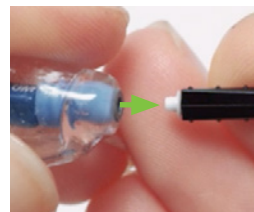

2. Carefully pull the stick out straight out.

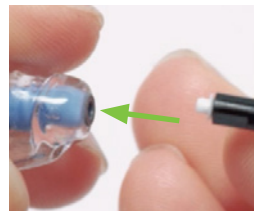

3. Rotate the stick and position the new filter towards the tip of the earpiece.



4. Gently insert the new filter into the opening of the earpiece. Lift the stick away and the filter should sit securely in the earpiece.

### Note:

CeruStop are available only for acrylic or titanium SlimTip earpieces. SlimTip Silicone earpieces do NOT have the CeruStop wax option available.

## CeruShield™ Disk – wax protection system for SDS 4.0 receivers

CeruShield™ Disk is the Phonak proprietary wax protection system, specially designed to be compatible with SDS 4.0 receivers only. All receivers are equipped with a CeruShield™ filter placed inside the receiver spout.

We suggest changing the CeruShield™ filter when the hearing aid volume or sound quality is reduced or if the receiver spout looks dirty.

Each CeruShield™ Disk has 8 fresh CeruShield™ wax filters and 8 positions for used filters.

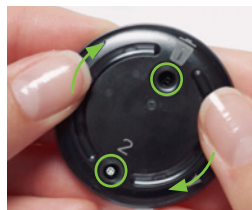

1. Lightly rest your thumbs on the turning areas. Do not press down. Rotate the cover of the CeruShield™ Disk so that there is an empty spot under the  icon and a new filter is visible below the 2.



2. To remove the filter from the receiver spout, orientate the opening of the receiver spout downwards facing the .

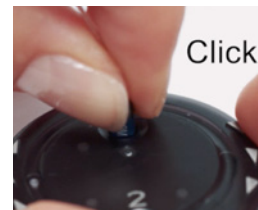

3. Press the receiver firmly down until you feel a click, then lift the receiver up. The used filter should remain inside the CeruShield™ Disk.

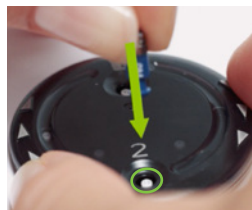

4. New filters can be easily accessed in the cavity indicated by the 2. To insert a new filter, orientate the receiver spout straight down towards the new filter.

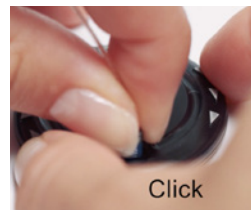

5. Firmly press the receiver down until you feel a click.



6. Lift the receiver up. The new CeruShield™ filter is securely positioned in the receiver spout.

# Life is on

At Phonak, we believe that hearing well is essential to living life to the fullest. For more than 70 years, we have remained true to our mission by developing pioneering hearing solutions that change people's lives to thrive socially and emotionally. Life is on.

[www.phonakpro.com](http://www.phonakpro.com)