

Phonak Target™ 1.0

Desktop fitting guide

To prepare the hearing instruments for the fitting session.

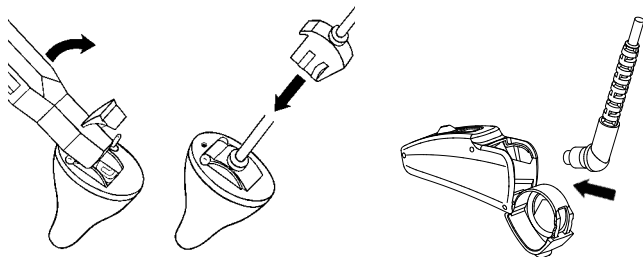

iCube

Insert the battery and turn the hearing instrument on by closing the battery compartment.

NOAHlink or HI-PRO

Connect the programming cables to the hearing instruments and to the fitting device.

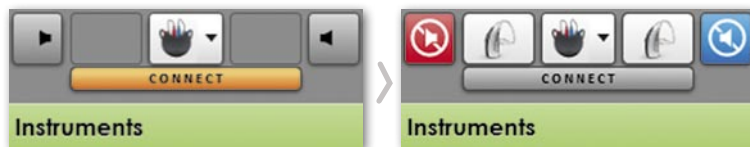

1.

Confirm that the correct fitting device is shown. To change the fitting device, use the pull down menu. Click **[CONNECT]** to start the fitting. The connected instruments will appear.

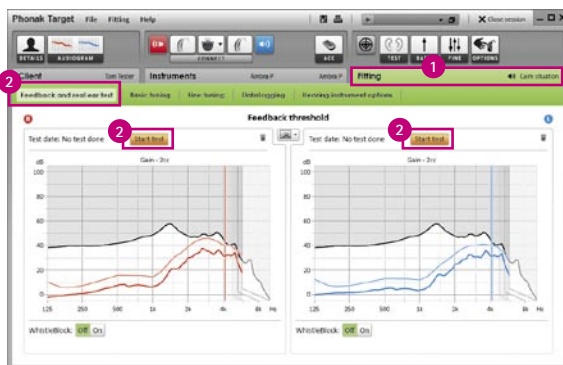

2.

1. Click on the tab **[Fitting]**.

2. In the screen **[Feedback and real ear test]** click **[Start test]** to run the test. To use the test results to calculate the acoustic parameter settings, select the check box **[Use predicted RECD and vent]**.



3.

1. Go to **[Basic tuning]** if adjustments to **[Gain level]**, **[Occlusion compensation]** or **[BassBoost]** are desired.

2. Click **[Close session]** to save the settings to the hearing instruments and the data base.

Phonak Target™ 1.0

Tips and Tricks

To program accessories



Phonak Target™ identifies connected accessories automatically; just plug them in during the fitting session. The identified accessories are shown in the dashboard next to the connected hearing instruments.

Accessories can also be manually selected in the tab **[Instruments] > [Accessories]**.

Make sure that the accessories are connected to your fitting computer via the USB cable.

During the save procedure the accessories are listed in the save dialog.

To use the speech banana in counseling



Click on the tab **[Client] > [Audiogram]**.

Select **[Show speech spectrum]** in the audiogram section to display the client's hearing loss within the speech banana.