

Phonak Paradise

Connecting to your cell phone

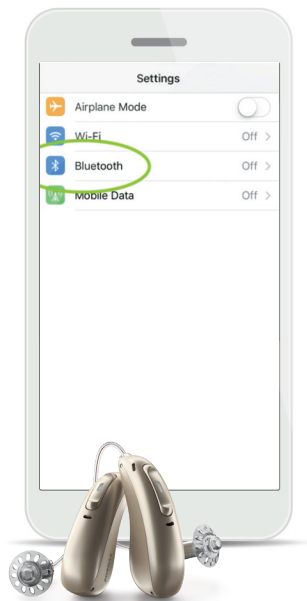

1.



2.

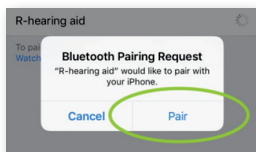

1. Bluetooth® menu

Open the Bluetooth menu on your phone (often found in "Settings" or "Tools"). Make sure Bluetooth is on.

2. Pairing

Switch the hearing aids off and on again (long press of the "down" button) to initiate pairing. The name of one hearing aid will appear on the phone. Tap on it to select, and click "pair" if prompted.

Experience the convenience of Tap Control

With a simple double tap at the top of your ear, you can access a variety of Bluetooth functions.

Default Tap Control Settings

- L** or **R** Accept/End phone call
- L** Pause/Resume streaming
- R** Start/Stop voice assistant

Voice Assistant

Note: Voice Assistant must be enabled in your phone settings

- Double tap the **R** ear to activate your phone's voice assistant.
- Ask the voice assistant to send a message to someone in your contact list.
- Dictate a message to the contact, and confirm to send!

Streaming

- Find your favorite song on Spotify, Amazon Music, iTunes, etc.
- Press "Play" and the music will stream directly to both devices, in stereo.
- Double Tap the **L** ear to stop streaming. Double tap again to resume.

Phone Calls

- Ask a friend to call your cell phone.
- When you hear the ring tone through your hearing aids, double tap either **L** or **R** ear to accept the call.
- When you're done, double tap either ear to end the call.

Note: Tap Control is exclusively available on rechargeable Paradise devices in Premium (90) and Advanced (70) performance levels.