



Manufacturer:

Phonak AG
Laubisrütistrasse 28
CH-8712 Stäfa
Switzerland

www.phonak-us.com



029-0370-03/V1.00/2016-04/Printed in USA © Phonak AG All rights reserved

Phonak Sky™ V

(V90/V70/V50)

User Guide



PHONAK
life is on

This user guide is valid for:

Wireless models

Phonak Sky V90-M	2016
Phonak Sky V90-P	2016
Phonak Sky V90-SP	2016
Phonak Sky V90-UP	2016
Phonak Sky V90-RIC	2016
Phonak Sky V70-M	2016
Phonak Sky V70-P	2016
Phonak Sky V70-SP	2016
Phonak Sky V70-UP	2016
Phonak Sky V70-RIC	2016
Phonak Sky V50-M	2016
Phonak Sky V50-P	2016
Phonak Sky V50-SP	2016
Phonak Sky V50-UP	2016
Phonak Sky V50-RIC	2016

CE mark applied



Your hearing aid details

i If no box is checked and you do not know the model of your hearing aid, please ask your hearing care professional.

Model

<input type="checkbox"/> Sky V-M (V90/V70/V50)	312
<input type="checkbox"/> Sky V-P (V90/V70/V50)	13
<input type="checkbox"/> Sky V-SP (V90/V70/V50)	13
<input type="checkbox"/> Sky V-UP (V90/V70/V50)	675
<input type="checkbox"/> Sky V-RIC (V90/V70/V50)	13

Battery type

Earpiece

- ☐ Dome
- ☐ Classic earmold
- ☐ cShell
- ☐ SlimTip

Your hearing care professional:

┌

┐

└

┘

Your hearing aids have been developed by Phonak — the world leader in hearing solutions based in Zurich, Switzerland.

These premium products are the result of decades of research and expertise and are designed to keep you connected to the beauty of sound! We thank you for making such a great choice and wish you many years of listening pleasure.

Please read the user guide carefully to make sure that you understand and get the best out of your hearing aids. For more information about features and benefits, simply contact your hearing care professional.

Phonak — life is on
www.phonak-us.com

Download the Phonak Support App

To have an individual and interactive user guide always with you, download the Phonak Support App on your mobile device. For more information please visit: www.phonak-us.com/supportapp



Contents

Your hearing aid

- | | |
|-----------------------------|----|
| 1. Quick guide | 8 |
| 2. Parts of the hearing aid | 10 |

Using the hearing aid

- | | |
|--------------------------------------|----|
| 3. Left & right hearing aid markings | 13 |
| 4. On/Off | 14 |
| 5. Batteries | 15 |
| 6. Putting on the hearing aid | 19 |
| 7. Removing the hearing aid | 21 |
| 8. Push button/indicator light | 23 |
| 9. Volume control | 25 |

Further Information

- | | |
|---|----|
| 10. Roger for conversation in noise and over distance | 26 |
| 11. Use of Roger receiver | 28 |
| 12. Other wireless accessories | 33 |
| 13. Care and maintenance | 34 |
| 14. Service and warranty | 37 |
| 15. Compliance information | 39 |
| 16. Information and description of symbols | 43 |
| 17. Troubleshooting | 48 |
| 18. Important safety information | 51 |

- | | |
|---|----|
| 19. Important information: Cell phones | 60 |
| 20. For the US market only, complies with the FDA regulations | 62 |

1. Quick guide

Left & right hearing aid markings

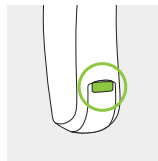

Sky V-M

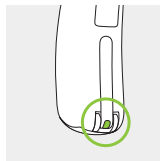

Sky V-P, V-SP, V-UP,
V-RIC

Blue marking for **left**
hearing aid.

Red marking for **right**
hearing aid.

Changing batteries

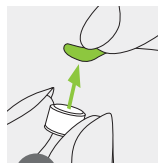

1

Remove the sticker from the new battery and wait two minutes.

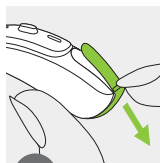

2

Open the battery door. For secured battery doors refer to chapter 5.2.

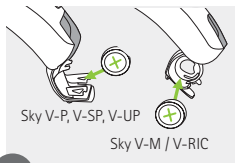

3

Place battery in the battery door with the "+" symbol facing upwards.

On/Off

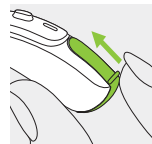

On

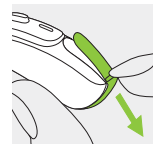

Off

For instruction for secured battery doors refer to chapter 5.2.

Push button/indicator light

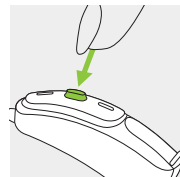

The push button on your hearing aid can have various functions. For indicator light refer to chapter 8.

Volume control

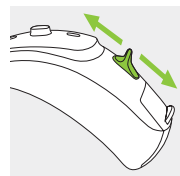

Sky V-P, V-SP, V-UP and V-RIC:
To increase the volume, press the volume control upwards. To decrease the volume, press the volume control downwards.

2. Parts of the hearing aid

The pictures below show the models described in this user guide. You can identify your personal model by:

- Checking "Your hearing aid details" on page 3.
- Or comparing your hearing aid with the following shown models. Pay attention to the shape of the hearing aid and if a volume control is present.

Possible earpieces for different models

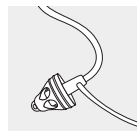

Dome
Sky V-M/P/RIC

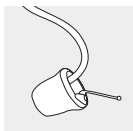

SlimTip
Sky V-M/P/RIC

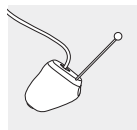

cShell
Sky V-RIC



Classic earmold
Sky V-M/P/SP/UP

Sky V-M*

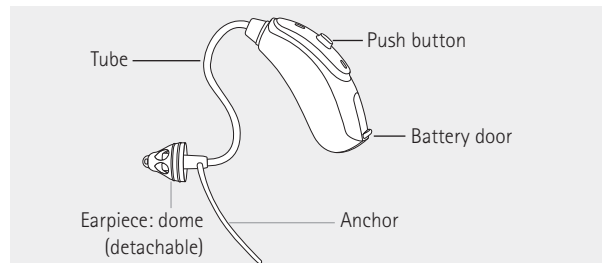

Sky V-P*, V-SP* & V-UP*

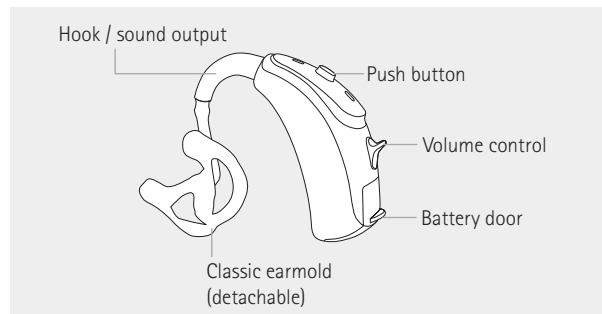

* Also available with secure solution for children below 36 months, refer to chapter 5.2

3. Left & right hearing aid markings

Sky V-RIC

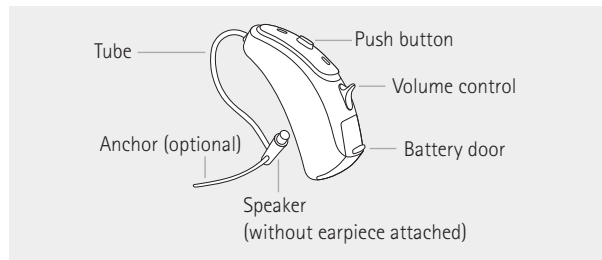

⚠ Sky V-RIC is not recommended for the use with children below 8 years.

There is a red or blue marking to tell you if it is a left or a right hearing aid.

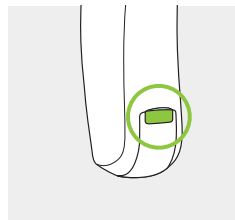

Sky V-M

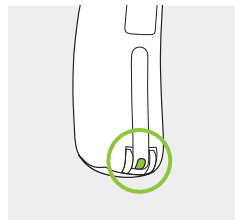

Sky V-P, V-SP, V-UP, V-RIC

Blue marking for **left hearing aid**.
Red marking for **right hearing aid**.

4. On/Off

The battery door is also the on/off switch.

To open secured battery doors refer to chapter 5.2.

1

Closed battery door =
hearing aid is **on**

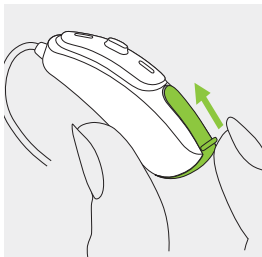

2

Open battery door =
hearing aid is **off**

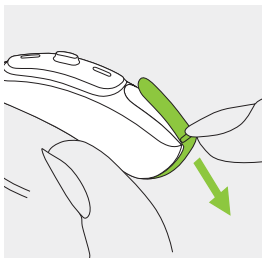

- ❗ When you switch on the hearing aid you may hear a start-up melody.

5. Batteries

5.1 Insert battery (standard battery doors)

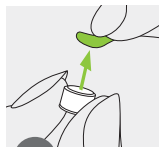

1

Remove the sticker from the new battery and wait two minutes.

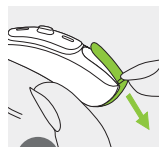

2

Open the battery door.

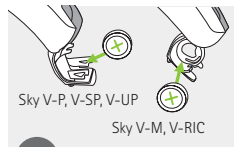

3

Place battery in the battery door with the "+" symbol facing upwards.

If the battery door is secured for smaller children continue to read the important information below, and refer to specific instructions in chapter 5.2 for inserting the battery.

- ❗ If it is difficult to close the battery door: Check that the battery is inserted correctly and the "+" symbol is facing upwards. If the battery is not inserted correctly, the hearing aid will not work and the battery door can be damaged.

 Low power: You will hear two beeps when the battery is low. You will have approximately 30 minutes to change the battery (this can vary, depending on the hearing aid settings and battery). We recommend that you always have a new battery on hand.

Replacement battery

This hearing aid requires zinc-air batteries. Identify the correct battery size (312, 13 or 675) by:

- Checking "Your hearing aid details" on page 3.
- Checking the marking on the inner side of the battery door.
- Checking the following table.

Model	Zinc-air battery size	Color marking on package	IEC code	ANSI code
Phonak Sky				
V-M	312	brown	PR41	7002ZD
V-P, V-SP, V-RIC	13	orange	PR48	7000ZD
V-UP	675	blue	PR44	7003ZD

 Please ensure you use the correct type of battery in your hearing aids (zinc-air). Please also read chapter 18.2 for further information on product safety.

5.2 Insert battery with a secured battery door

All Sky V models (except Sky V-RIC) can be fitted with a secured battery door if needed for safety reasons (children below 36 months). Before starting, please read the important information in chapter 5.1 regarding batteries.

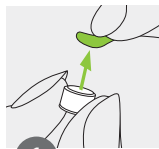

1

Remove the sticker from the new battery and wait two minutes.

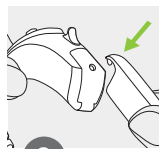

2

Open the secured battery door with the special tool given by your hearing care professional as picture 2 and 3 show, or use a pen tip.

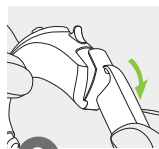

3

4

Place battery in the battery door with the "+" symbol facing upwards.

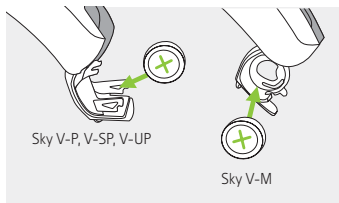

The battery is only secured when the battery door is closed properly. Always check after closing, that the battery door can't be opened by hand.

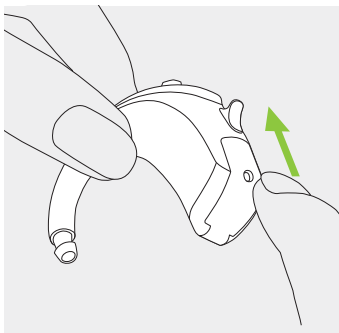

6. Putting on the hearing aid

6.1 Putting on the hearing aid with classic earmold

1

Take the earmold up to your ear and place the ear canal part into your ear canal.

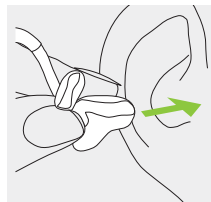

2

Place the hearing aid behind your ear.

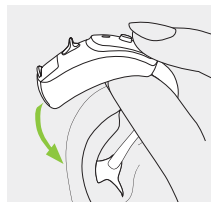

3

Insert the upper part of the earmold into the upper part of the bowl of your ear.

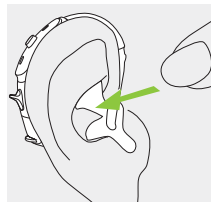

6.2 Putting on the hearing aid with dome, SlimTip or cShell

1

Place the hearing aid behind your ear.



2

Insert the earpiece into your ear canal.

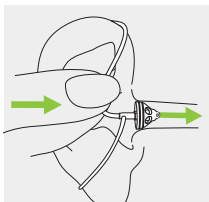

3

If there is an anchor attached to the earpiece, tuck it into the bowl of your ear to secure your hearing aid.

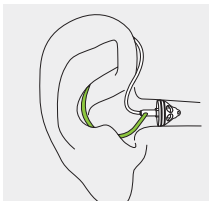

7. Removing the hearing aid

7.1 Removing the hearing aid with classic earmold

1

Lift the hearing aid above the upper part of your ear.

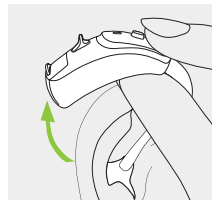

2

Grasp the earmold with your fingers and gently remove it.

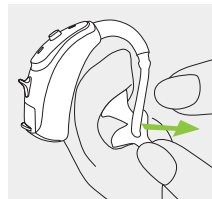

i Please try to avoid gripping the tube to remove the hearing aid.

7.2 Removing the hearing aid with dome, SlimTip or cShell

1

Gently pull on the bend of the tube and remove the hearing aid from behind the ear.

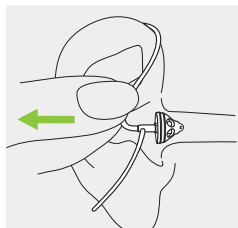

⚠ In very rare cases, your earpiece can remain in your ear canal when removing the hearing aid from the ear. In the unlikely case that the earpiece does get stuck in your ear canal, it is strongly recommended to see a medical specialist for safe removal.

8. Push button/indicator light

The push button on your hearing aid can have various functions or may not be active. This depends on the programming of the hearing aid which is indicated in your individual "Hearing aid instructions". Please ask your hearing care professional for this.



Optional indicator light integrated in push button

Parents and caregivers of infants and young children can easily be informed about the hearing aid status with an optional indicator light (all models except Sky V-RIC). The yellow indicator light is integrated in the push button and shows the status of the hearing aid as long as it is turned on. The light is optimally visible from the front. Your hearing care professional can activate/deactivate the indicator light in different ways.

9. Volume control

The complete list of the hearing aid status is shown below. Please ask your hearing care professional to mark what has been activated accordingly.

Status hearing aid	Indicator light pattern (yellow)
<input type="checkbox"/> Hearing aid is powered on	Repeating single blink ● ● ●
<input type="checkbox"/> Hearing aid is powered on and Roger is accessible	Repeating double blink ● ● ● ● ● ●
<input type="checkbox"/> Low battery*	Repeating triple blink ● ● ● ● ● ●
<input type="checkbox"/> Volume level change (either initiated by a remote control or by the push button)	Single blink per volume change ●
<input type="checkbox"/> Program change (either initiated by a remote control or by the push button)	Single blink per program change ●

* Low battery is signaled approx. 30 minutes before the battery needs to be changed. It is recommended that you always have a new battery at hand.

Sky V-P, V-SP, V-UP and V-RIC only:

To increase the volume, press the volume control upwards. To decrease the volume, press the volume control downwards.

The volume control can be disabled by the hearing care professional.

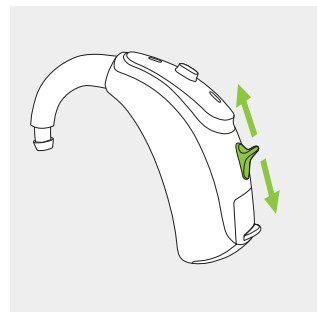

10. Roger™ for conversation in noise and over distance

Roger accessories help communication in noise and over distance by wirelessly sending the speaker's voice directly to your hearing aids. Roger includes both a microphone and receiver. Some Roger microphones also support input from audio sources via Bluetooth® or cable.

Microphone: worn or placed close to the speaker, or connected to the audio source, directly transmits the sound to your receiver without disruptive background noises.

Receiver: attached to your hearing aids behind the ear or worn on your body using a neckloop.

Combining your Phonak Sky V hearing aids with a Roger wireless microphone enables you to hear and understand more speech in these challenging situations.
www.phonak.com/roger

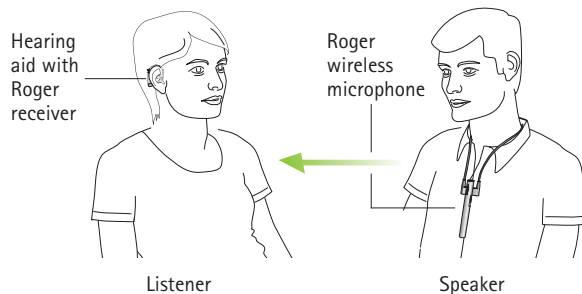

Ask your hearing care professional for a Roger demo and more information.

11. Use of Roger receiver

11.1 Design-integrated Roger receiver

Phonak Sky V-P / V-SP / V-UP / V-RIC can be equipped with a design-integrated Roger receiver.

With the design-integrated receiver attached, the hearing aid offers all functionalities and usability as without the receiver. The hearing aid with the design-integrated receiver is water resistant, refer to chapter 13.

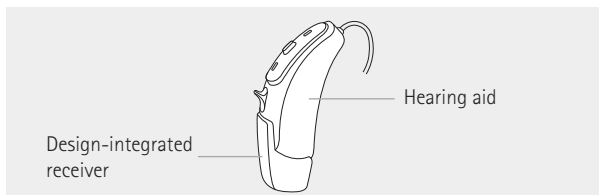

⚠ Your hearing care professional has already prepared your hearing aid for use with the design-integrated receiver, and this part can not be removed. Please ask your hearing care professional for further information.

11.2 Audio shoe and Roger X receiver

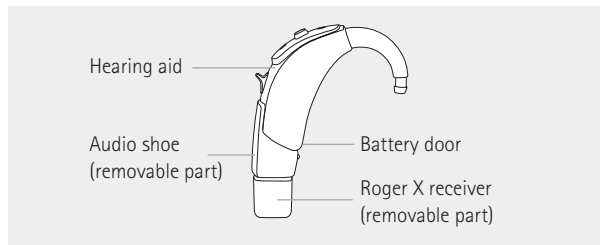

With the audio shoe and Roger X receiver attached, the hearing aid offers the same functionalities and usability as without the receiver with one important exclusion:

⚠ Your hearing aid with the audio shoe is no longer water resistant.

Attach the audio shoe

1

Push the audio shoe towards the bottom of the hearing aid. Match the grooves of both parts.

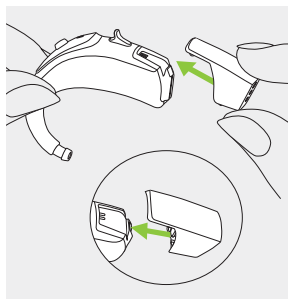

2

Push until it snaps into place and is properly attached to the hearing aid. A Roger X receiver can now be attached.

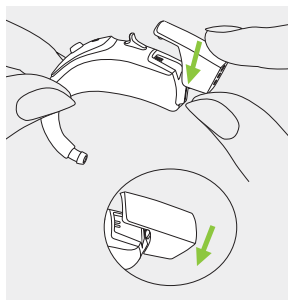

Attach the Roger X receiver

1

Push the three pins of the Roger X receiver into the three sockets of the audio shoe. The Roger X receiver is correctly attached when it is clicked into place.

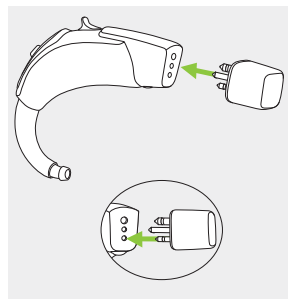

Please refer to the specific receiver user instruction for further information.

⚠ To hear immediately the Roger microphone signal when required, Phonak recommends to leave the Roger X receiver attached when not in use.

Remove the audio shoe

1

Take the hearing aid between thumb and forefinger. Pull the locking system on the audio shoe back.

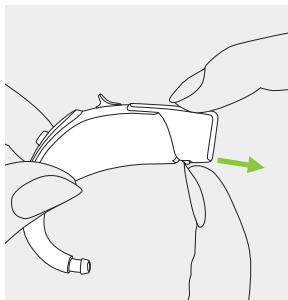

2

Pull the audio shoe upwards with the other hand. The audio shoe is now removed from the hearing aid.

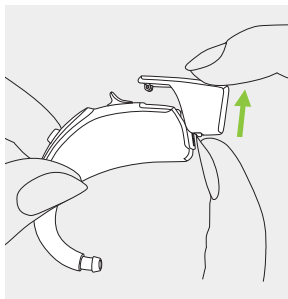

12. Other wireless accessories

A range of Phonak accessories are available for you to use with your hearing aid.

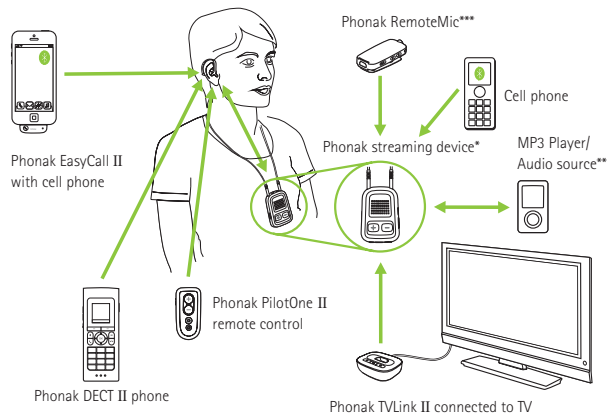

* The Phonak ComPilot II with neckloop or ComPilot Air II with clip to attach to clothing. They also have basic remote control functionalities. For advanced control they can be used with the Phonak RemoteControl App.

** Audio sources (e.g. MP3 Player, computer, laptop, tablet) can be connected to the streaming device via Bluetooth or audio cable.

*** Clipped onto the speaker's clothing for better understanding over distance.

13. Care and maintenance

Diligent and routine care of your hearing aid contributes to outstanding performance and a long service life.

Please use the following specifications as a guideline. For further information regarding product safety, see chapter 18.2.

General information

Before using hair spray or applying cosmetics, you should remove your hearing aid from your ear, because these products may damage it.

When you are not using your hearing aid, leave the battery door open so that any moisture can evaporate. Make sure that you always completely dry your hearing aid after use. Store the hearing aid in a safe, dry and clean place.

Your hearing aids are resistant to water, sweat and dust under the following conditions:

- The battery door is fully closed. Ensure that no foreign object such as hair is caught in the battery door when it is closed.
- After exposure to water, sweat or dust, the hearing aid is cleaned and dried.
- The hearing aid is used and maintained as described in this user guide.

① Hearing aids with the design-integrated Roger receiver are also water resistant.

① Hearing aids with an audio shoe and Roger X receiver are not water resistant.

① Use of your hearing aid around water can restrict air flow to the batteries causing it to stop working. Should your hearing aid stop working after coming into contact with water, refer to the troubleshooting steps in chapter 17.

14. Service and warranty

Daily

Inspect the earpiece and tube for earwax and moisture deposits. Clean the surfaces with a lint-free cloth or use the small brush provided in the hearing aid hard case. Never use cleaning agents such as household detergents, soap, etc. for cleaning your hearing aid. It is not recommended to rinse these parts with water, risk for lodging in the tube. If you need to clean your hearing aid intensively, ask your hearing care professional for advice and information on filters or drying capsules.

Weekly

Clean the earpiece with a soft, damp cloth or with a special cleaning cloth for hearing aids. For further maintenance or cleaning instructions, please see your hearing care professional.

Monthly

Inspect your hearing tube for color changes, hardening, or cracks. In the case of such changes, the hearing tube has to be replaced. Please see your hearing care professional.

Local warranty

Please ask the hearing care professional, where you purchased your hearing aid, about the terms of the local warranty.

International warranty

Phonak offers a one year limited international warranty, valid starting from the date of purchase. This limited warranty covers manufacturing and material defects in the hearing aid itself, but not accessories such as batteries, tubes, earmolds and external receivers. The warranty only comes into force if a proof of purchase is shown.

The international warranty does not affect any legal rights that you might have under applicable national legislation governing sale of consumer goods.

Warranty limitation

This warranty does not cover damage from improper handling or care, exposure to chemicals or undue stress. Damage caused by third parties or non-authorized service centers renders the warranty null and void. This warranty does not include any services performed by a hearing care professional in their office.

Serial number
(left side):

Authorized hearing care
professional (stamp/signature):

Serial number
(right side):

Date of purchase:

15. Compliance information

Europe:

Declaration of Conformity

Hereby Phonak AG declares that this Phonak product meets the requirements of the Medical Devices Directive 93/42/EEC as well as the Radio and Telecommunications Terminal Equipment Directive 1999/5/EC. The full text of the Declaration of Conformity can be obtained from the manufacturer or the local Phonak representative whose address can be taken from the list on www.phonak.com (Phonak worldwide locations).

Australia/New Zealand:



R-NZ

Indicates a device's compliance with applicable Radio Spectrum Management's (RSM) and Australian Communications and Media Authority (ACMA) regulatory arrangements for the legal sale in New Zealand and Australia.

The compliance label R-NZ is for radio products supplied in the New Zealand market under conformity level A1.

The wireless models listed on page 2 are certified under:

Phonak Sky V-M (V90/V70/V50)

USA	FCC ID: KWC-WHSBTEM
Canada	IC: 2262A-WHSBTEM

Phonak Sky V-P (V90/V70/V50)

USA	FCC ID: KWC-WHSBTEP
Canada	IC: 2262A-WHSBTEP

Phonak Sky V-SP (V90/V70/V50)

USA	FCC ID: KWC-BTEVSP
Canada	IC: 2262A-BTEVSP

Phonak Sky V-UP (V90/V70/V50)

USA	FCC ID: KWC-BTEVUP
Canada	IC: 2262A-BTEVUP

Phonak Sky V-RIC (V90/V70/V50)

USA	FCC ID: KWC-WHSRIC4
Canada	IC: 2262A-WHSRIC4

Notice 1:

This device complies with Part 15 of the FCC Rules and with RSS-210 of Industry Canada. Operation is subject to the following two conditions:

- 1) this device may not cause harmful interference, and
- 2) this device must accept any interference received, including interference that may cause undesired operation.

Notice 2:

Changes or modifications made to this device not expressly approved by Phonak may void the FCC authorization to operate this device.

Notice 3:

This device has been tested and found to comply with the limits for a Class B digital device, pursuant to Part 15 of the FCC Rules and ICES-003 of Industry Canada. These limits are designed to provide reasonable protection against harmful interference in a residential installation. This device generates, uses and can radiate radio frequency energy and, if not installed and used in accordance with the instructions, may cause harmful

interference to radio communications. However, there is no guarantee that interference will not occur in a particular installation. If this device does cause harmful interference to radio or television reception, which can be determined by turning the equipment off and on, the user is encouraged to try to correct the interference by one or more of the following measures:

- Reorient or relocate the receiving antenna.
- Increase the separation between the device and receiver.
- Connect the device into an outlet on a circuit different from that to which the receiver is connected.
- Consult the dealer or an experienced radio/TV technician for help.

16. Information and description of symbols



With the CE symbol, Phonak AG confirms that this Phonak product – including accessories – meets the requirements of the Medical Devices Directive 93/42/EEC as well as the R&TTE Directive 1999/5/EC on radio and telecommunications equipment. The numbers after the CE symbol correspond to the code of certified institutions that were consulted under the above-mentioned directives.



This symbol indicates that the products described in these user instructions adhere to the requirements for an applied part of Type B of EN 60601-1. The surface of the hearing aid is specified as an applied part of Type B.



Indicates the medical device manufacturer, as defined in EU Directive 93/42/EEC.



This symbol indicates that it is important for the user to read and take into account the relevant information in these user guides.



This symbol indicates that it is important for the user to pay attention to the relevant warning notices in these user guides.



Important information for handling and product safety.



During transportation keep dry.

**Operating
conditions**

The product is designed such that it functions without problems or restrictions if used as intended, unless otherwise noted in these user guides. The hearing aids are classified IP68 (depth of 1 meter for 60 minutes) and designed to be used in all daily life situations. Therefore you do not have to worry about getting the hearing aids exposed to a rain shower or sweat. However, the hearing aid is not intended to be used in water activities that includes chlorinated water, soap, salt water or other liquids with a chemical content.

SN

Indicates the manufacturer's serial number so that a specific medical device can be identified.

REF

Indicates the manufacturer's catalogue number so that the medical device can be identified.



Temperature during transportation and storage:
-20° to +60° Celsius (-4° to +140° Fahrenheit).



Humidity during transportation: Up to 90% (non condensing).

Humidity during storage: 0% to 70%, if not in use.
See instruction in chapter 19.2 regarding drying
the hearing aid after use.



Atmospheric pressure: 200 hPa to 1500 hPa



The symbol with the crossed-out garbage bin is to make you aware that this hearing aid may not be thrown away as normal household waste. Please dispose of old or unused hearing aids, at waste disposal sites intended for electronic waste, or give your hearing aid to your hearing care professional for disposal. Proper disposal protects the environment and health.

17. Troubleshooting

Problem	Causes
Hearing aid not functioning	Dead battery Blocked speaker/earpiece Battery not inserted correctly Hearing aid switched off
Hearing aid whistles	Hearing aid not inserted correctly Earwax in ear canal
Hearing aid not loud enough or distorted	Volume too loud Low battery Speaker/earpiece blocked Volume too low Physical hearing condition has changed
Hearing aid plays two beeps	Indication for low battery
Hearing aid switches on & off (intermittent)	Moisture on battery or hearing aid
Light indicator not blinking	Flat battery Battery not inserted correctly Light indicator not activated

❗ If the problem persists, contact your hearing care professional for assistance

What to do
Change battery (chapter 1 + 5) Clean speaker opening/earpiece Insert battery correctly (chapter 1 + 5) Switch hearing aid on by completely closing the battery door (chapter 4) Insert hearing aid correctly (chapter 6) Contact your ENT/GP or hearing care professional Decrease volume (chapter 8 + 9) Change battery (chapter 1 + 5) Clean speaker opening/earpiece Turn volume up if volume control available (chapter 8 + 9) Contact your hearing care professional
Change battery within the next 30 minutes (chapter 1 + 5) Wipe battery and hearing aid with dry cloth
Change battery (chapter 1+5) Insert battery correctly (chapter 1+5) Contact your hearing care professional

18. Important safety information

Please read the information on the following pages before using your hearing aid.

A hearing aid will not restore normal hearing and will not prevent or improve a hearing impairment resulting from organic conditions. Infrequent use of a hearing aid does not permit a user to attain full benefit from it. The use of a hearing aid is only part of hearing habilitation and may need to be supplemented by auditory training and instruction in lipreading.

18.1 Hazard warnings

 The intended use of hearing aids is to amplify and transmit sound to the ears and hereby compensate for impaired hearing. The hearing aids (specially programmed for each hearing loss) must only be used by the intended person. They should not be used by any other person as they could damage hearing.

 Changes or modifications to the hearing aid that were not explicitly approved by Phonak are not permitted. Such changes may damage your ear or the hearing aid.

 Do not use the hearing aids in explosive areas (mines or industrial areas with danger of explosions, oxygen rich environments or areas where flammable anesthetics are handled).

 Hearing aid batteries are toxic if they are swallowed! Keep out of reach of children, individuals with cognitive impairment, and pets. If batteries are swallowed, consult your physician immediately!

 Tamperproof (secured) solutions for the battery door, ear hook and design-integrated Roger receiver (if used) must be attached for children younger than 36 months to prevent accidental swallowing of the battery or small parts of the device. In case one of these secured mechanisms is damaged by applying too much force or using an inappropriate tool, the device should be brought to your hearing care professional for repair or exchange.

 If you feel pain in or behind your ear, if it is inflamed or if skin irritation and accelerated accumulations of earwax occur, please check with your hearing care professional or physician.

 In very rare cases, the dome can remain in your ear canal when removing the hearing tube from the ear. In the unlikely case that the dome does get stuck in your ear canal, it is strongly recommended to see a physician for safe removal.

 Hearing programs in the directional microphone mode reduce background noises. Please be aware that warning signals or noises coming from behind, e. g. cars, are partially or entirely suppressed.

 Phonak Sky V-RIC model is not for children below 36 months. It contains small parts that can cause choking, if swallowed by children. Keep out of reach of children, individuals with cognitive impairment, and pets. If swallowed, consult a physician or hospital immediately.

 Do not make a wire connection from your hearing aid to any external audio sources like radio etc. That could cause injuries on your body (electric shock).

 The following is only applicable for persons with active implantable medical devices (i.e. pacemakers, defibrillators, etc.):

- Keep the wireless hearing aid at least 15 cm (6 inches) away from the active implant. If you experience any interference, do not use the wireless hearing aids and contact the manufacturer of the active implant. Please, note that interference can also

be caused by power lines, electrostatic discharge, airport metal detectors etc.

- Keep magnets (i.e. battery handling tool, EasyPhone magnet, etc.) at least 15 cm (6 inches) away from the active implant.

 Hearing instruments should not be fitted with domes / wax protection systems when used by clients with perforated eardrums, inflamed ear canals or otherwise exposed middle ear cavities. In these cases, we recommend the use of a custom earpiece. In the unlikely case that any part of this product should remain in the ear canal,

it is strongly recommended to see a medical specialist for safe removal.

18.2 Information on product safety

- ① Phonak hearing aids are water resistant and not waterproof. They are designed to withstand normal activities and occasional accidental exposure to extreme conditions. Never immerse your hearing aid in water! Phonak hearing aids are not specifically designed for extended periods of water submersion on a continual basis, that is worn in activities such as swimming or bathing. Always remove your hearing aid before these activities, as the hearing aid contains sensitive electronic parts.
- ① Never wash the microphone inputs. Doing so could cause it to lose its special acoustic features.
- ① Protect your hearing aid from heat (never leave near a window or in the car). Never use a microwave or other heating devices to dry your hearing aid. Ask your hearing care professional about suitable drying methods.
- ① The dome should be changed every three months or when it becomes stiff or brittle. This is to prevent the dome from detaching from the tube spout during insertion into or removal from the ear.
- ① When you are not using your hearing aid, leave the battery door open so that any moisture can evaporate. Make sure that you always completely dry your hearing aid after use. Store the hearing aid in a safe, dry and clean place.
- ① Do not drop your hearing aid! Dropping onto a hard surface can damage your hearing aid.
- ① Always use new batteries for your hearing aid. In case a battery is leaking, replace it immediately with a new one to avoid any skin irritation. You can return used batteries to your hearing care professional.

❗ The batteries used in these hearing aids should not exceed 1.5 Volts. Please do not use silver-zinc or Li-ion (lithium-ion) rechargeable batteries as these may cause severe damage to your hearing aids. The table in chapter 5 explains exactly which type of battery your particular hearing aids require.

❗ Remove the battery if you are not using your hearing aid for a long period of time.

❗ Special medical or dental examination including radiation described below, may adversely affect the correct functioning of your hearing aids. Remove and keep them outside the examination room/area before undergoing:

- Medical or dental examination with X-ray (also CT scan).
- Medical examinations with MRI/NMRI scans, generating magnetic fields.
Hearing aids don't need to be removed when passing security gates (airports etc.). If X-ray is used at all, it will be in very low doses, and will not affect the hearing aids.

❗ Do not use your hearing aid in areas where electronic equipment is prohibited.

19. Important information: Cell phones

Some hearing aid users have reported a buzzing sound in their hearing aids when they are using cell phones. According to the ANSI 63.19 (American National Standard Methods of Measurement of Compatibility between Wireless Communications Devices and Hearing Instruments) standard, the compatibility of a particular hearing aid and cell phone can be predicted by adding the rating for the hearing aid immunity to the rating for the cell phone emissions. The sum of the hearing aid rating (e.g. M2/T2=2) and the telephone rating (e.g. M3/T3=3) is 5, and any combination that equals 5 will provide "normal use"; a sum of 6 or greater would indicate "excellent performance". The equipment performance measurements, categories and system classifications are based upon the best information available but cannot guarantee that all users will be satisfied. The immunity of this hearing aid is at least M2/T2.

Note: the performance of individual hearing aids may vary with individual cell phones. Therefore, please try the hearing aid with your cell phone or, if you are purchasing a new phone, be sure to try it with your hearing aid prior to purchase. For additional guidance, please ask your hearing care professional for the booklet entitled "hearing aid compatibility with digital wireless cell phones".

20. For the US market only, complies with the FDA regulations

Warning to Hearing Aid Dispensers

A hearing aid dispenser should advise a prospective hearing aid user to consult promptly with a licensed physician (preferably an ear specialist) before dispensing a hearing aid if the hearing aid dispenser determines through inquiry, actual observation, or review of any other available information concerning the prospective user, that the prospective user has any of the following conditions:

- (i) Visible congenital or traumatic deformity of the ear.
- (ii) History of active drainage from the ear within the previous 90 days.
- (iii) History of sudden or rapidly progressive hearing loss within the previous 90 days.
- (iv) Acute or chronic dizziness.

- (v) Unilateral hearing loss of sudden or recent onset within the previous 90 days.
- (vi) Audiometric air-bone gap equal to or greater than 15 decibels at 500 hertz (Hz), 1,000 Hz, and 2,000 Hz.
- (vii) Visible evidence of significant cerumen accumulation or a foreign body in the ear canal.
- (viii) Pain or discomfort in the ear. Special care should be exercised in selecting and fitting a hearing aid whose maximum sound pressure level exceeds 132 decibels because there may be risk of impairing the remaining hearing of the hearing aid user. (This provision is required only for those hearing aids with a maximum sound pressure capability greater than 132 decibels (dB).)

Important Notice for Prospective Hearing Aid Users

Good health practice requires that a person with a hearing loss have a medical evaluation by a licensed physician (preferably a physician who specializes in diseases of the ear) before purchasing a hearing aid.

Licensed physicians who specialize in diseases of the ear are often referred to as otolaryngologists, otologists or otorhinolaryngologists. The purpose of medical evaluation is to assure that all medically treatable conditions that may affect hearing are identified and treated before the hearing aid is purchased.

Following the medical evaluation, the physician will give you a written statement that states that your hearing loss has been medically evaluated and that you may be considered a candidate for a hearing aid. The physician will refer you to an audiologist or a hearing aid dispenser, as appropriate, for a hearing aid evaluation.

The audiologist or hearing aid dispenser will conduct a hearing aid evaluation to assess your ability to hear with and without a hearing aid. The hearing aid evaluation will enable the audiologist or dispenser to select and fit a hearing aid to your individual needs.

If you have reservations about your ability to adapt to amplification, you should inquire about the availability of a trial-rental or purchase-option program. Many hearing aid dispensers now offer programs that permit

you to wear a hearing aid for a period of time for a nominal fee after which you may decide if you want to purchase the hearing aid.

Federal law restricts the sale of hearing aids to those individuals who have obtained a medical evaluation from a licensed physician. Federal law permits a fully informed adult to sign a waiver statement declining the medical evaluation for religious or personal beliefs that preclude consultation with a physician. The exercise of such a waiver is not in your best health interest and its use is strongly discouraged.

Children with Hearing Loss

In addition to seeing a physician for a medical evaluation, a child with a hearing loss should be directed to an audiologist for evaluation and rehabilitation since hearing loss may cause problems in language development and the educational and social growth of a child. An audiologist is qualified by training and experience to assist in the evaluation and rehabilitation of a child with a hearing loss.

Notes

[illegible][illegible]